

FAD CF85

HUB REDUCTION - CONCRETE PUMPER SPEC

8 X 4 RIGID. THE ULTIMATE ALL ROUNDER.

DEALER SUPPORT + BODY BUILDER FRIENDLY CHASSIS = THE SMART CHOICE

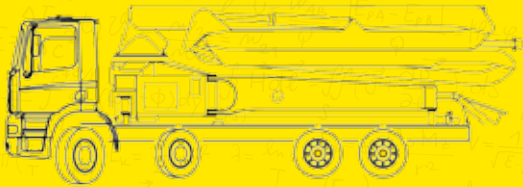

AT A GLANCE

GVM: 40000 kg*

GCM: 58000 kg*

Max Output: Up to 510 hp (375 kW) at 1500-1900 rpm

Max Torque: Up to 1850 lb/ft (2500 Nm) at 1000-1410 rpm

* Maximum GVM and GCM figures shown may exceed certain Australian state regulations.



DO THE MATH. BUY A DAF.

daf.com.au

DAF

A **PACCAR** COMPANY

FAD CF85

HUB REDUCTION - CONCRETE PUMPER SPEC

8 X 4 RIGID. THE ULTIMATE ALL ROUNDER.

PACCAR MX ENGINE

PACCAR:	6 cylinder, turbo intercooled
Piston displacement:	12.9 litres
Compression ratio:	17.7 to 1 (16.5 to 1 for MX375)
Fuel injection:	Electronically controlled
Type:	MX 340
Max. output:	460 hp (340 kW) at 1500-1900 rpm
Max. torque:	1700 lb/ft (2300 Nm) at 1000-1410 rpm
Type:	MX 375
Max. output:	510 hp (375 kW) at 1500-1900 rpm
Max. torque:	1850 lb/ft (2500 Nm) at 1000-1410 rpm

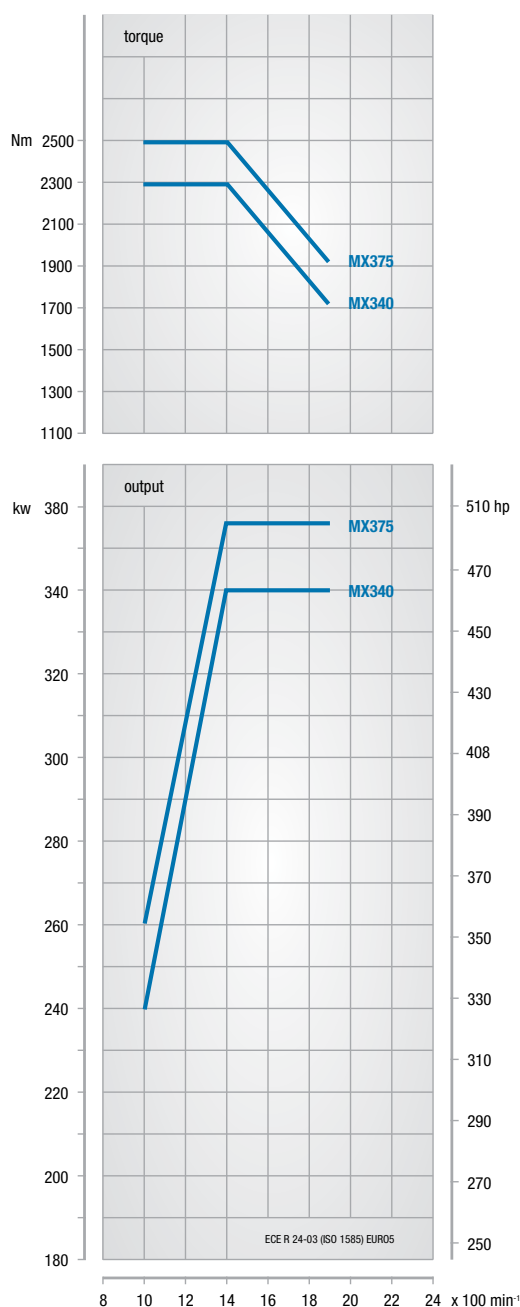

CHASSIS

Completely flat topped chassis frame; Riveted and bolted construction of channel-section main frame members and cross members; 1 x 430 litre aluminium fuel tank; Fuel tank height – 620 mm; 1 x 40 litre AdBlue tank; Horizontal box type silencer at RHS with horizontal exit to RHS; Spray suppression behind steer tyre; Front Under-run Protection System (FUPS); Dimensions main frame members: 310 x 75 x 7 mm with inner reinforcement (position and length depending on WB/AE).

Options:

+ 340 litre aluminium fuel tank	+ 2 x 430 litre aluminium fuel tanks
+ Vertical exhaust discharge	+ Spare wheel carrier with spare wheel (only with single fuel tank)

GEARBOX

ZF Synchronised Manual – 16-speed overdrive manual gearbox with oil cooler, 16S2500-13.80/0.84.

Options:

	MX 340	MX 375
16S2500-13.80/0.84	X	X

CLUTCH

ZF Synchronised Manual: Single type, pulled operation, asbestos free, dry plate, hydraulically operated and pneumatically assisted; Self adjusting

Diameter: 430 mm

Option:

AS-Tronic: Single type, pushed operation, asbestos free, dry plate, electronically operated, self adjusting servo

Diameter: 430 mm

FRONT AXLE

Type: 2 x 186N

Max. design load: 18000 kg

I-section axle. Stub axles with needle bearings.

REAR AXLE

Type: DAF HR 135T

Max. design load: 26000 kg

Double drive tandem axle with hub reduction and lockable inter axle and cross axle differentials; Crown wheel and pinion with spiral bevel primary reduction and straight spur hub reduction (only with DAF suspension).

Ratios: 4.05

FRONT SUSPENSION

Parabolic type leaf springs with shackled ends at rear - maintenance free. Shock absorbers and stabiliser bar.

Spring dimensions: 1x1800x80x31 + 1x1800x80x29 mm (9000 kg)

REAR SUSPENSION	
DAF 8 bag air suspension	
Max. design load:	26000 kg
Options:	
+ DAF trapezium leaf suspension. Spring travel limiting cables. Axle location with 8 reaction rods. Mounted on spring units which pivot on a central trunnion located by 8 torque rods. (26000 kg)	

WHEELS AND TYRES	
22.5" (10 stud 335 PCD) Alcoa aluminium satin disc wheels	
Options:	
+ Alcoa Dura-Bright wheels	+ 315 / 80R 22.5 drive tyres
+ 385 / 65R 22.5 steer tyres	

STEERING	
Type:	Hydraulic power steering with adjustable steering column for rake and height.

COLOURS	
Cab colour:	M8870 Ice White
Chassis colour:	Black
Mirror cover:	Cab colour
Bumper colour:	Cab colour
Options:	
+ Various non-standard and metallic cab and chassis colours available. <i>Ask your local dealer for a colour guide.</i>	

BRAKE SYSTEM	
Dual circuit air operated drum brakes on rear axles with automatic slack adjusters. Front axle air operated disc brakes with wear indicator on instrument panel.	
Disc Brake dimensions:	430 x 45 mm
Drum Brake dimensions:	420 x 200 mm (Rear axle HR 1355T)
EBS (Electronic Braking System incorporating ABS); Emergency/parking brake with spring brake actuators on rear axles; MX Engine Brake and exhaust brake (retardation power 320 kW at 2100 rpm); ASR (Anti Slip Control); Hill Start Aid (with AS-Tronic only).	
Options:	
+ ZF intarder only with AS-Tronic (retardation power 420 kW)	

ELECTRICAL EQUIPMENT	
Voltage:	24 V
Alternator:	80 A
Batteries:	2 x 175 Ah
Starter motor:	24 V
Rear light units:	Incorporating direction indicator light, stop light, reversing light, side marker light and reflector; Reverse warning alarm.
Battery isolation:	Main switch with manual control located near the battery box.

TRAILER EQUIPMENT	
No trailer connections	
Options:	
Trailer brake connectors:	2-line to rear of chassis 24 V EBS
Trailer light connectors:	24 V

CAB EXTERIOR	
Day Cab with 4 coil spring suspension and hydraulic tilting device; Tilting angle 57.5°; Fixed, illuminated cab steps; Manually controlled roof hatch; Heated and electrically adjustable main and wide angle mirrors; Steel front bumper with foot hold; Combi lights, incorporating driving and fog lights in lower bumper; External sun visor; Corner air deflectors; Side collars; Air horns; Rear window.	
Options:	
+ Sleeper Cab	+ Air horns (double set Space Cab only)
+ Adjustable roof spoiler	+ Remote hatch control (Space Cab only)
+ Space Cab with skylight	

CAB INTERIOR	
High quality trim and upholstery in natural camel-grey colour; Cab floor cover includes easy-clean top layer in camel-grey; Cockpit style dashboard, including DIP (driver information panel) and AdBlue indicator; Adjustable luxury air suspended driver seat and fixed co-driver seat with head restraint; Various storage facilities including two cup holders, containers behind seat and overhead compartments; 4 spoke, soft grip steering wheel with integrated control switches; Electric windows (driver and passenger); Black dashboard finish; Cruise control; Personal road speed limiter; Integrated 3-point seat belt; Air conditioning; Antennas: 2 x GSM; Radio/USB/MP3 player with 6 speakers; Remote control door lock; FMS connector prepared (Fleet Management System); Driver's seat arm rest (only with AS-Tronic).	
Option:	
+ Hands free telephone kit*	+ Passenger luxury air seat
+ 3rd seat (Day Cab only)	+ Additional upper bunk (only with Sleeper or Space Cab)
+ Leather finish steering wheel	+ SRS air bag (Driver) with seat belt pretensioner on driver and passenger seats
+ Lane departure warning system	+ Bunk with Sleeper or Space Cab (height depending on refrigerator and storage boxes)
+ Refrigerator (not available with Day Cab or rear window)	+ Wood structure dashboard finish
* Subject to phone compatibility, bluetooth adaptor not included	

POWER TAKE OFF (PTO)	
Engine speed control connector; PTO prepared.	
Options:	
+ Various types of PTOs / position combinations – refer to DAF Trucks Australia	

LEGAL COMPLIANCE	
+ Exhaust Emission Euro 5 ADR 80/03	+ ECE R29 Cab Certification
+ ADR 83/00 Noise Certification	+ Front Under-run Protection Certification

APPLICATION CONDITIONS	
Air intake with cyclonic filter on cab roof; Standard tool kit; Fuel water separator.	
Options:	
+ Cyclonic air intake behind the cab	

MAX. SPEED	
All vehicles are speed limited to 100 km/h.	

FAD CF85

HUB REDUCTION - CONCRETE PUMPER SPEC

8 X 4 RIGID. THE ULTIMATE ALL ROUNDER.

Safety & Technology

SCR - Selective Catalytic Reduction

DAF uses SCR technology – Selective Catalytic Reduction. This SCR technology offers an effective solution to comply with European Euro V emission requirements. SCR technology is simple, reliable and efficient. SCR is an after-treatment system applied to all current PACCAR Euro V engines, and is used in conjunction with an advanced high-pressure fuel injection system.

EBS

- + Anti-lock Braking System (ABS)
- + Anti-Slip Control (ASR)
- + Brake assist
- + Drag torque control
- + Hill Start Aid (with AS Tronic Only)

DRIVER SUPPORT SYSTEMS

- + Adaptive Cruise Control (ACC) with Forward Collision Warning (FCW) - Option
- + LaneDeparture Warning System (LDWS) - Option
- + Axleload Monitoring (ALM) - Option (air suspension only)

VISION

- + Side view camera system - Option
- + Front kerb mirror (Option) and side view mirrors
- + HID Xenon headlights - Option

PASSIVE SAFETY SYSTEMS

- + Seat belt reminder
- + Airbag and seat belt pre-tensioners - Option

Technical

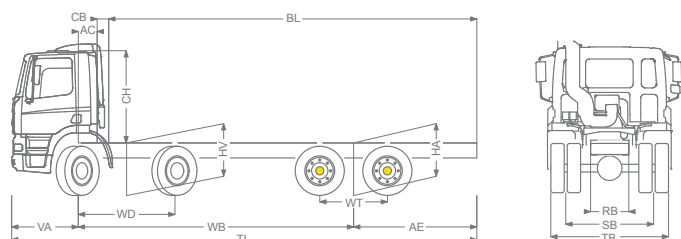

KEY POINTS

- 1 Chassis and Cab Weight calculated with: standard specification items and empty fuel tank.
- 2 CB is based on standard air intake and/or exhaust.
- 3 Cab height is measured from frame member to closed cabin roof hatch. With air intake on cab roof: +0.14m.
- 4 Calculate customer specific BL with TOPEC.
- 5 Unladen height at centre of driven axle(s).
- 6 Laden height at centre of driven axle(s).
- 7 TK = turning circle between kerbs (For comparison purposes only).
- 8 TW = turning circle between walls (For comparison purposes only).
- 9 Unladen height at centre of front axle(s).
- 10 Laden height at centre of front axle(s).

	Wheelbase - AE		Unladen Weight ⁹⁾			Variable dimensions									
	WB	AE	Front	Rear	Total	AC	CB ²⁾	CH ³⁾	BL ⁴⁾	TL	HA ⁵⁾	HA ⁶⁾	TK ⁷⁾	TW ⁸⁾	
Day	6.375	2.95	6880	3720	10600	0.39	0.20	1.91	8.76	10.73	1.17	1.12	22.10	23.54	
Other dimensions		VA: 1.405		HV ⁹⁾ : 1.17		HV ¹⁰⁾ : 1.13		RB: 0.79		SB: 1.82		TB: 2.45		WD: 2.00	WT: 1.40

* Other wheelbase options available. Please see your DAF dealer for more information.

*Other wheelbase options available. Please see your DAF dealer for more information.

3 YEAR / 750,000KMS WARRANTY

Conditions apply. For full warranty details, please contact your local DAF dealer.

The information contained in this spec sheet is for general information purposes only. Please note that the specifications listed above are formulated for a "Base Model" DAF truck. Depending on the vehicle configuration a specific option may not be possible. All weights and measurements stated relate to the basic specification and may vary should different specifications be chosen. In the interest of product improvements, DAF Trucks Australia reserves the right to change these specifications without prior notice. For further information please contact DAF Trucks Australia or your nearest dealership.

CONTACT

DAF Trucks Australia
PO Box 60, Bayswater VIC 3153